



the Mistletoe Express



A Publication of Historic Mistletoe Heights

January 2004

Quick Bits

MANY, MANY THANKS!

Thank you to Leslie Houston for offering the use of her home for our 2003 MHA Christmas Party.

January Calendar

January 1 - HAPPY NEW YEAR!

January 7 - FWISD Students Return to School

January 17 - Stock Show/Rodeo

January 19 - Martin Luther King, Jr. Day. No school FWISD.

January 27 - Fort Worth South's Third Annual Banquet

January 30, February 1 - Stock Show Days FWISD

Cat Needs A Home

Friendly, young, black and white male cat needs home. If interested, please contact Irene at 817-926-6546.



Gateway Village Update Meeting

On Monday night, November 24th, a tentative site plan for the former armory site (NE corner of Forest Park and Rosedale) was unveiled by Terry Montesi, Chairmen of Trademark Property Company. His objective was to update residents of nearby neighborhoods on the status of the mixed-use development now under contract by Fort Worth South, Inc.

Although Trademark has begun marketing the lodging, office, retail and residential components of the site, confirmation by actual tenants is still down the road. Montesi did share a high-density, mixed-use site plan with the audience.

The development has been dubbed Midtown - obviously for it's close-in location. Montesi said the moniker will create an identity for this area of town. He sees this Midtown "urban village" as spurring development on other nearby tracts of land that are sitting vacant or under-used.

Construction of Midtown will include a tower or some other strong architectural icon to capture the eye and distinguish the site. Ground breaking will probably start this coming summer and the center may be open for business by summer of 2005. Stay tuned for updates on the project as details emerge and tenants sign on.

On a related topic, Fort Worth South, Inc. (FWS) has recommended a high level review of alternatives to the rebuilding of Rosedale as currently planned (118 ft. wide, 6-lane divided boulevard). This rebuilding would harm the ability to successfully redevelop the area as a mixed-use, pedestrian friendly neighborhood, people just would not walk across a wide highway.

The alternative suggested is a narrower, five-lane plan (2 lanes each with a center left-turn lane), with wider sidewalks and heavily landscaped parkway edges. FWS's Board of Directors is considering potential next steps.

Martin Herring

Inside the Express

New Neighbors	2
Central Market Foodie Card	2
Irwin Street Block Party	3
Remodeling Tips	4
Fort Worth South Banquet	4
Letter from the President	5
Indoor Winter Gardening	6
Newby Park Pavilion	7
Household Guide	8
Remembering Frank Mills	8
Restaurant Review	8
Neighborhood Classified Ads	9

Street Lamp Decorations

The following neighbors deserve our thanks for decorating the streetlights on their respective blocks. If you see them taking them down in the first week of January you might even offer to help.

THANKS, NEIGHBORS!

Kyle Carr, Amy Linehan, Gary Willis, Ingrid Kelly, Gill DeHoyas, the Stewarts, Stephanie Mischke, Tom Brewer, Scott Doty, John Hastings, John Key, the Bradburys, Lynn Herrera, Wyatt Teague [X2], Jim/Amy Pannell, David Bakutis, Scott Harwell, Betty Arvin, the Judges, Simone Scott, Medfords, Rochelle Graham and Shelton Boys.

DON'T FORGET - The Decorations Need to Come Down After New Year's Day!

New Neighbor Welcome

Welcome to all our new residents. If you know of someone new to the neighborhood, please contact Joy Teague at 817-923-2330.

2312 Mistletoe Drive

Kent and Rebecca McKeever. Kent is with Ellis & Tinsley Realtors. Rebecca works at Alamo Title Company. They have no children. Both are long-time Fort Worth residents and moved here from Stadium Drive.

2210 Weatherbee Street

Bob and Elise Jackson and their two young sons. Bob works for Burlington Resources. They relocated here from Farmington, N.M.

Wedding Congratulations

Grant Ellis, a lifetime MH resident, was married in October. (Actually, he doesn't live here now, but there's always hope!)

Terri Ellis

Central Market Fund-Raising Foodie Card

I couldn't help but notice, each time I stood in the express line checkout at Central Market, that Trinity Valley and Fort Worth Country Day had raised thousands of dollars with Fund-Raising Foodie cards. I always say that 50% of my job is asking stupid questions, so pretty soon I got started. What is a Fund-Raising Foodie card? How do you get one? Does Lily B. Clayton participate? Can I have a card? While I'm at it, can I get some more for my neighbors? As of this writing, I've "placed" 17 cards, and I'd like to keep going until everyone in our neighborhood has one (and, I hope, is using it).

When you use your Lily B. Clayton Fund-Raising Foodie card at Central Market, a whopping 5% of the check you write goes to Lily B. Clayton elementary school. (You just give it to your checker to be scanned along with your purchases.)

"Why are you doing this?" has been a frequently-asked question. I believe what's good for the neighborhood is good for me, and there's no doubt in my mind that having a thriving elementary school is good for our neighborhood. Lily B. is undoubtedly instilling the kind of values in our neighborhood's children that led us to restoring our beautiful old houses rather than building McMansions.

Join me in supporting Lily B. If you don't already have a card, please let me know and I'll be happy to bring you one.

Results from October 28, 2003: Trinity Valley was leading with 6227.20. Lily B. Clayton was dead last with 644.43 and needs your support.

Heather White
817-923-6574



ANIMAL House



Lonnie & James Stack
(817) 370-1056
www.animalhousepetsitting.com
Bonded & Insured

Mistletoe Heights

Home Enhancement Tips #5

It's a proven fact people react more favorably to property shown under bright light. Consider brightening your home. Here's how:

- Clean windows
- Use adequate wattage in light bulbs
- Replace older fluorescent lamps, which darken with age
- Use mirrors to magnify the feeling of light & space
- Use light wall colors
- Most importantly, open drapes and blinds and turn on lights before showings



Gaye Reed (M.H. resident since 1976)
Truly your neighborhood Realtor®



(817) 921-8164
gaye.reed@coldwellbanker.com



Circle the Block

Last summer the 2200 block of Mistletoe Avenue had a block social. We thought it was so much fun, that the 2300 block of Irwin decided to do it in October.

In spite of poor publicity and dampish, cool weather, we had a great turnout. There was good food on everyone's porch who participated (especially Gay and Martin's, to no one's surprise who knows them!), and lots of neat conversation.

But I nominate my house the most popular, because I had special guests! Chloe Davis was born in my house in 1923. She has great stories about the neighborhood in the early years. She and her husband, John, who lived on Clara as a kid, not only stayed the entire time, visiting and telling people about life when Mistletoe Heights was the nicest new neighborhood in town, but they graciously brought a list of people who lived on Irwin at the time. If you don't see your address here, come and ask!

Kathy McReynolds

	A	B	C
1	IRWIN	PRESENT	1941
2	2300 Irwin St	Gallagher, Peter A Etux Lori	Paul Anderson
3	2301 Irwin St	Farman, Richard Etux Martha E	Bowhart
4	2304 Irwin St	Perkins, Kenneth Etux Kimberly	Ballard
5	2305 Irwin St	Duvall, Duncan E & Sue	Rankin
6	2308 Irwin St	Hansen, Erik Etux Kathryn C	J E Foster
7	2309 Irwin St	Swartzwelder, Shirley Jo	Helm
8	2311 Irwin St	Elbert, Ernest M & Rebecca	
9	2312 Irwin St	McReynolds, Kathy	Tom W Moore
10	2313 Irwin St	Lienemann, J Etxir William	Wingate, Cheatham
11	2315 Irwin St	Hull, George Monroe	
12	2316 Irwin St	Soderbergh, Bo Etux Lori	Bill Nye, Carter, Young
13	2317 Irwin St	Brown, Nancy V	Butler
14	2320 Irwin St	Dougherty, Patrick Etux Michel	Fred Linington
15	2321 Irwin St	Houston, Leslie Etxir Ellis	Goertler
16	2324 Irwin St	Bourland, Robert Jr Etux Anne	Ed Shotts, Mickey Griffith
17	2328 Irwin St	Betsill, Laura Michelle	Talbot
18	2329 Irwin St	Sisk, Betty R	Ed Fulwiler
19	2332 Irwin St	Kelly, Steven J	Marshall Kennady
20	2333 Irwin St	Gross, Robert D	Sheppard
21	2335 Irwin St	Martinez, Roy	Langworthy
22	2336 Irwin St	Herring, Martin K Etux Theresa	Misses Babb
23			

We're there when you need a helping hand...



Agape Home Care Inc.

Personal Care for Your Loved One at Home

817-336-HOME (4663)

24 Hours • 7 Days Per Week
www.agapehomecare.com

- Companionship/Sitters
- Hands-on Personal Care
- Meal Preparation
- Light Housekeeping
- Transportation/Errands
- Rapid Response Time
- Medication Setup/Assistance
- Licensed, Bonded, & Insured
- Locally owned since 1996 by Registered Nurses

New Dance Studio in Fort Worth!

Todd Edson's

Park Place Dance Center

Creative Movement, Ballet, Jazz, Tap, Modern, Yoga & Pilates
also Mommy & Me

- Classes for students 3 years old and up
- Professional staff of current and former dancers
- Home of the *Bruce Wood Dance Company*
- Beautifully renovated central Fort Worth location

We're in the neighborhood. Come & grow with us today!
1622 Park Place Ave., 76110 tel. 817.927.6500

Cowtown Massage

Let My Hands
Relieve Your Stress!



We offer Swedish, Sports
and Total Relaxation!

Call Now for an Appointment

817-921-6100

For Residence Outcalls, please call 817-714-5784

Great Fort Worth Location (TCU Area)
\$40.00 One Hour Saturday Special

Removing Trim for Reuse

Taking trim off cleanly so that it can be installed again is a common order on many home-repair projects, whether you're replacing windows or laying a new floor. The following steps will help you take it off without harming the wood—or yourself.

STEP 1: Score through the caulk seal between the trim and the wall. This will free up the trim and protect the wall's finish coat.

STEP 1: SCORE

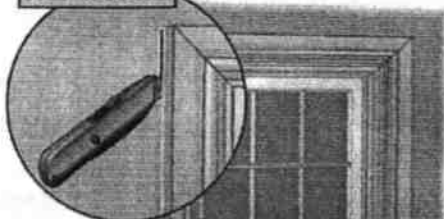

STEP 2: Working end to end, pry up the trim with a small pry bar or the claw of a hammer. A putty knife slipped behind the pry bar will spare finished walls from dents. To keep the trim from splitting, get your tool as close to the nails as possible, and pry gently.

STEP 2: PRY

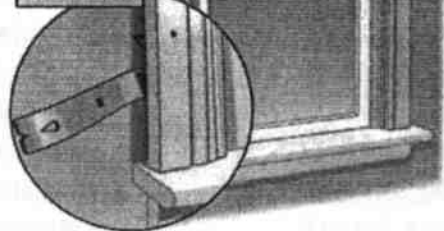

STEP 3: Preserve the face of the trim by pulling the finish nails out from the back side with end nippers.

STEP 3: PULL NAILS

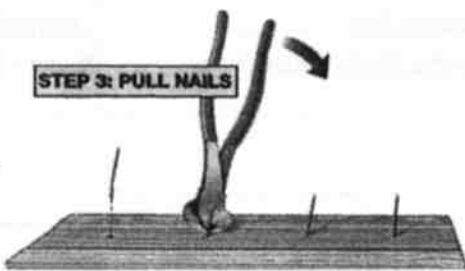

—Mark Powers

Save the Date!

January 27, 2004
Fort Worth South's Third Annual Banquet
Visit www.fortworthsouth.org or call Nancy Berger (817) 923-1343 for details.



John R. Boyd, CTC
Owner

2501 Forest Park Blvd.
Fort Worth, Texas 76110 (817) 921-5561

Remember When...

Remember when the phone numbers began with two letters, and the two letters were the beginning of a word? Well, looking through some old pieces of memorabilia it can be found that the prefixes that are dominant in Mistletoe Heights (924, 926, & 927) were designated Walnut or WA. So the next time you are feeling particularly nostalgic give your phone number as Walnut 6 or Walnut 7, just for fun.



Consultation
Design
Maintenance

*Mistletoe Mowers
& Landscaping*

Chris Guerra

(817) 926-5890

mistletoemowers@hotmail.com

"The difference between good and great is the details."

**TERRY
RESTORATIONS**

*Craftsmanship
and
Creativity*



Terry Restorations specializes in the restoration of fine homes. We bring the home you love up to today's standards of comfort, style and amenities. Whether you want a complete home renovation, your kitchen or bath updated, or have any type of remodeling need, please call Terry restorations, where craftsmanship and creativity come together to offer you the best in restoration and remodeling.

*For more information,
call Jim Broussard at 817-917-9988*

Letter from the President

I want to start by thanking John Key, the MHA President for the last two+ years, for the tremendous effort he has made to ensure the continued success of Mistletoe Heights. I feel honored by the vote of confidence by the Association in making me the new President, and will work to the best of my abilities to continue moving our neighborhood forward.

I have been coming to Mistletoe Heights all my life. Both my parents lived here when they were children, and our family often visited my grandmother's house at 2246 Harrison until 1988. Even as a child, I realized the unique quality of the neighborhood, and had a chance to see the inevitable cycle of houses falling into disrepair, then being bought and restored by new, enthusiastic owners.

When my wife, Rose Lynn, and I moved here sixteen years ago, I was surprised at the number of neighbors that were in their second, or even third, Mistletoe Heights home. I have always used this as an example of the desirability of our neighborhood when explaining to "outsiders" where we live and why. Now Rose Lynn and I carry on that tradition, having moved this year, all the way across the street.

We have seen lots of changes during our stay here. Other family members are around the corner, and the number of kids on the block is at an all time high. I have to think that they know, even now, that they live in a special place. Hopefully, we can make sure that these lovely homes will still be here when they grow up and become homeowners.

The best way to ensure this is to be involved in the neighborhood. We have a major project, the Newby Park Pavilion, that is well into the planning stages. Our regular neighborhood events, such as the Pot Luck Supper - Easter Egg Hunt - Fourth of July Parade and Ice Cream Social - our regular meetings, and impromptu events (more rock and roll?) can always use a few extra hands. For our neighbors who have not yet attended these events, you have a Norman Rockwell treat in store for you. So get out and get involved, enjoy the season, enjoy being in your homes and enjoy being with your neighbors.

See you in the neighborhood.

Jeff Gibbons

J J Robb Real Estate Services

The Jeff and Rob Group



www.jeffandrobb.com
www.oldhomespecialists.com
Office 817-924-8358
Fax 817-926-3065

Specializing in Classic Older and Historic Properties

We know the area, the properties and the architecture. We also know all the ins and outs of older homes; financing, inspections, tax credits and historic guidelines. Most of all, we have an undeniable affection for the classic neighborhoods of historic south Fort Worth.

Our dedication to service and quality is evident in our many years of diligent work in promoting, developing and repopulating our urban village.

Call us when you are ready to sell, or when you are ready to find your *new* old home.

1255 W. Magnolia Ave., Fort Worth, Texas

**DESIGNER'S
RESOURCE
STUDIO**

ESTABLISHED 1992



**Custom Picture
Framing**

**...AND WE'RE
IN THE
NEIGHBORHOOD!**

*Expert Design Assistance
Conservation Materials
Artwork
Photographs
Memorabilia*

**1612 Park Place
(817) 922-9048**

Indoor Gardening for Winter

Probably the most popular type of indoor gardening is a collection of several plants in open containers. Needed plants, supplies, and equipment can be bought at a garden center or a retail outlet.

First, choose a suitable location in your home. It need not be sunny, as one can provide incandescent or fluorescent lamps. Some plants require direct sunlight, some only indirect light. Most indoor plants, when purchased, have a label that shows how much light is required.

Most plants like fairly humid air. You can place the plant containers in saucers or in trays that contain moistened pebbles, sand or bits of charcoal. Evaporation will provide humidity for the plants. Plants can be misted to provide humidity. Be sure to keep them away from any other plants you may have for a couple of weeks to make sure the plants are free of insects and disease. Keep the soil moist during this time. They should be watered only when the soil below the surface feels dry. Do not fertilize for a while, as the professional growers give them enough to last for a while.

Plants can be washed under the bathroom shower or in the kitchen sink using a lukewarm spray. Large plants can be cleaned by gently wiping the leaves with a damp cloth or sponge. Sometimes, the stems need to be pinched back to help them bush out, and to produce more blossoms on the flowering plants.

Happy Gardening,
Patsy Slocum



LOST KITTY

"Callie" has been missing since December 1 from Irwin St. She is a heavy calico female with no collar. If you can help locate Callie please call Duncan and Sue Duvall at **817-926-8714**.



Straight Line Painting

Tom Long
Owner

Call for free estimates: **817-832-2053**
Serving Fort Worth/Metroplex **Cert # A203015153**



FORT WORTH REMODELING

TODD DAILEY, SR.

Design / Build
Kitchens / Baths
Tile / Hardwoods
Cabinetry

Phone 817-692-6793
Fax 817-922-8370
dmic@airmail.net

MCH TILE

**Residential/Commercial
Design & Installation**

Showers • Tubs • Walls • Floors

Countertops • Entryways

Leaks Repaired

**Free Estimates
110% Price Guarantee**

(817) 308-7101



More Information on the Newby Park Pavilion

The Committee on the proposed Newby Park Pavilion and other enhancements have been working on ideas for fundraisers, and will be issuing a leaflet soon describing how the engraved bricks can be ordered, contributions made, and further projects. Our architect, Karl Komatsu has issued a site plan, and hopefully, we can obtain a building permit in the near future. All plans, however, depend on the generosity of our neighborhood and the obtaining of corporate funding.

If you have not had the opportunity to see what the Pavilion will closely resemble, take the time to visit the train station at the Fort Worth Zoo's Texas Wild exhibit. It will resemble an old-time train station, will have water available for meetings of our Association, and will be lighted at night, with ceiling fans for use in the summertime.

It is planned to use the engraved bricks in or around the Pavilion. These may be ordered at any time for \$100 each, with a maximum of 3 lines with 13 characters per line including spacing. Checks or money orders may be made out to "Friends of Newby Park" and all donations are tax deductible. It's a good way to honor a friend, relative, a memorial for a loved one, or for business advertisement.

For further information you can call Patsy Slocum at 817-923-5510 or email PHSFtW@aol.com or any other committee member.



One of a kind pieces

Private Showings Available!

2737 8th Ave., Fort Worth, TX • 817-207-8800 • Fax 817-207-8827

10% OFF
Jewelry Repair
With coupon only
Not valid with any other offer

\$2.99
Watch Battery
Included
(Most Brands)
With coupon only
Not valid with any other offer

ABBEY'S
PET
- AND -
HOUSE SITTING

"WHILE THE CAT'S AWAY...
WE KEEP THE MICE COMFORTABLE!"

817-735-1486

Bonded • Insured • Excellent References
Member Pet Sitters International
Employment Opportunities

Over 7 Years In Business!

On The Road Again?

**Professional Pet Care
Right in Your Own Home!**

Daily Visits • Mid-Day Walks
Overnight Stays • Yard Waste Removal

**Fort Worth's #1 Professional
Pet Sitting Company**

Kelly & Mary Claire Sullivan, Owners

**ANIMAL
House
Maids**

Home Cleaning Service
Bonded & Insured

Laura Stack
817-370-1056

Household Guide for the Tarrant County Bride

My own dear bride (Kathy McReynolds) found a 1923 book put out by the Tarrant County Clerk about the time Mistletoe Heights was being built. I intend to excerpt it [verbatim] for the newsletter from time to time, as follows:

To clean combs - Tie one end of a silk thread to the handle of a washstand. Seat yourself before it with a napkin spread on your lap, and holding the other end of the thread tightly in your left hand, take the comb in your right hand and pass it hard and carefully along the silk, which should be made to go in between the teeth of the comb separately, so as to remove or scrape out all the impurities. Then rub the comb with a brush or soft cloth; rinse it in warm soapsuds and wipe it dry.

To keep moths from fur and woolen clothes - In May brush fur and woolen clothes, wrap them tightly up in linen and put them away in drawers. Pepper or red cedar chips are a good preservative from moths, but camphor is the best.

To Clean Stone Steps and Stairs - Where there are large flights of stone steps and flagged pathways, the process of cleaning is a long and tedious one. The common method of cleaning with a hearthstone, or caked whitening, not only gives a smeary appearance, but washes off with a shower of rain. The preparation which we here give not only has a great preference in appearance, but, in the long run saves labor; as with it twice a week is sufficient for whitening, and the remaining days washing will be found sufficient. Take a gallon of water, and color it to the intensity of deep blue with stone-blue. Boil in it a pound of white size, and dissolve it in a quarter pound of whitening and three cakes of pipe clay, stirring it well about. Wash over the steps with this solution in a light, quick manner, and afterwards finish with clean water in the usual way.

FULL CIRCLE EMPORIUM

- Antiques • Shabby Chic
- Collectibles • Handbags
- Handcrafted Jewelry
- Trapp Candles • and MORE!

ESCAPE THE MALL CROWDS!
Tired of the same old gift-shopping choices? Come by and discover the unique, the different – the perfect gift for that special someone. Always new treasures to discover!

Bring in this ad for
\$5.00 OFF
With Any Purchase Of
\$20 or more!
(1 coupon per customer)

817-921-2066 3460-A Bluebonnet Circle
Wed-Fri 11-6 • Sat 10-4 • Tues by appointment

Remembering Frank Mills

In our neighborhood he was known as "The Mayor of Mistletoe," but to all of North Texas he was the pioneering voice of radio and TV.

"With his voice, Texas entered age of TV," headlined the Dallas Morning News story announcing the death of our long-time neighbor Frank Mills. Mr. Mills and his wife, Nancy, moved to their Mistletoe Blvd. home in the spring of 1961, but it was in the fall of 1948 that he signed on WBAP-TV, ushering in the age of television to Texas. For the next 30 years, he was chief announcer, FM director, production manager and public affairs coordinator at WBAP, now KXAS-TV (Channel 5).

In 1936, Mr. Mills came to Texas where he went to work with WBAP radio. In later years he was said to be Amon Carter's favorite announcer; the Fort Worth Star-Telegram and WBAP owner requested that his funeral be broadcast with Mr. Mills as the announcer.

Closer to home, it was Mr. Mills and Mistletoe Blvd. neighbor Jim King who were the co-founders of the Mistletoe Heights Association. We're sure there are many of you who recall his contributions to our neighborhood; if you wish, please send a Letter to the Editor with any memories you would like to share.

Mr. Mills died on December 16 at his daughter's home in Fort Worth. His grandson Lee Wills and family now live in the Mills home on Mistletoe Blvd.

Celaborelle Restaurant

If you have not eaten at Celaborelle Restaurant at 2257 Hemphill, you really must. It is a Mediterranean buffet, which I normally don't like, but this place is great. It is very inexpensive. Steve and I eat way more than two adults need, and it is less than fifteen dollars. I love the various dips and salads, but there are lots of meat and vegetarian dishes to choose from.

I challenge you to leave without eating too much! Every time I have been there, they have a large plate full of baklava, which may be why I am so miserable each time we leave. During the week they are only open for lunch. On Saturday, they are only open for dinner. Check it out. (Did I mention, it is extremely inexpensive?)

Kathy McReynolds

NEIGHBORHOOD CLASSIFIEDS

Ads are free for Mistletoe Heights residents and may be submitted to the editor. The deadline is the 20th of each month. Ads must be renewed monthly except for service classifieds (i.e.: babysitting, mowing, etc.), which are renewed yearly. Please notify the editor (carrk@charter.net) if you would like to renew, discontinue or update your ad.

Dreaming of a Lush and Texas-Tough Landscape?

Seeking to de-stress enjoying the beauty of butterflies and hummingbirds in your yard? If so, contact Alexia Strout-Dapaz at either (817) 921-4820 or at astroutdapaz@yahoo.com.

Estate Appraisals and Liquidation Service

Certified appraiser with the International Society of Appraisers, in business in Mistletoe Heights for over 10 years. Terri Ellis, Mistletoe Estate Sales, 926-9424.

Seeking a Dependable Housekeeper?

Our housekeeper is seeking additional MH clients. Currently, she works at 3 other houses on our block and at several other Mistletoe Heights addresses. Dependable, flexible, reliable and thorough. Interested in both short-term and long-term clients. Contact Alexia Strout-Dapaz at (817) 921-4820 or at astroutdapaz@yahoo.com to request her contact information.

Mary Kay Cosmetics

Paula Cady Russell at 2201 Mistletoe Blvd. is a Mary Kay consultant. Call her at 921-6377 for a free makeover, gift service or if you've "lost" your consultant.

Tax and Bookkeeping Services

Former IRS Agent with 15 years experience. Tax preparation for individuals. Bookkeeping and tax preparation for small businesses. Contact Jeri Jo Blackmon at 817-923-4393 or jerijo@charter.net.

Child Care Needed

2 days per week 8:00 AM - 5:00 PM for a well behaved 4 month old starting Jan. 16th Please call Kurt or Michelle at 817.920.5991.

Show Your Spirit



LINDBERG®

Ben Taylor Optical

1101 W. Rosedale • (817) 870-2061

Fund Your IRA Today!



Fully funding your IRA as early as possible each year can make a big difference in the amount of money you have at retirement.

Contribute \$3,000 to your IRA for 2003 and 2004 NOW!
If you're over age 50, you can contribute \$3,500.

Call today to schedule a FREE review of your retirement savings.



Bruce C. Border, CFP
2453 Forest Park Blvd.
Fort Worth, Texas 76110
817-926-8056

www.edwardjones.com
Member SIPC

Edward Jones

Serving Individual Investors Since 1871

Helpful Phone Numbers, Email Addresses and Websites

	Phone	Email	Website
City Code Violations	871-6320		
City of Fort Worth			www.fortworthgov.org
Police – Non-Emergency	335-4222		
Garage Sale Permits	871-7851		
Graffiti Abatement	871-5741		
Lily B. Clayton Elementary	922-6660		it.ftworth.isd.tenet.edu/116/
Paschal High School	922-6600		
Kate Singleton – Historical Preservation	871-8012	kate.singleton@fwgov.org	
Southside Preservation Hall	215-8600	HallTess@earthlink.net	www.southsidepreservation.com
The T/Longhorn Trolley	2158600		www.the-t.com
Trinity Railway Express	871-8809		www.trinityrailwayexpress.org
Wendy Davis – City Council District 9		district9@fortworthgov.org	ci.fort-worth.tx.us

MHA Officers	Street Reps (listed by blocks)		Publication Information
President	2200 W. Rosedale South	2100 Edwin	 <p>EDITORIAL POLICY</p> <p>Articles and letters to the Editor are welcomed. To be published as written, letters must be addressed to the Editor, signed and include a phone number. Anonymous letters will not be published. Articles may be submitted for publication, signed or unsigned, subject to approval and editing by the Editor. Letters to the Editor are limited to a half page (approximately 350 words). Please submit to carrk@charter.net or 2217 W. Rosedale St. So. <i>The deadline is the 20th of each month.</i></p> <hr/> <p>ADVERTISING INFORMATION</p> <p>To place an advertisement or for actual mechanical sizes, please call Nancy Brown at 923-7146. Ad rates are: business card size \$15, 1/4 page \$30, 1/3 page \$45, half page \$55, full page \$100, and pre-printed 8 1/2 x 11 insert flyers \$50. <i>The deadline is the 20th of each month.</i></p>
Jeff Gibbons 926-0079	Carrie Johnson 926-9776	Lynn Herrera 926-9991	
Vice-President	2300 W. Rosedale South	2200 Edwin	
Tom Richey 923-7352	Kimberly Helixon 927-4641	Wyatt Teague 923-2330	
Secretary	2200 Irwin	2300 Edwin	
The Peiperts 926-4117	Gary Willis 924-4000	Tom Richey 923-7352	
Treasurer	2300 Irwin	2100 Weatherbee	
Alex Blanton 926-1972	Ingrid/Steve Kelly 921-0768	Tanya Dohoney 924-4968	
Newsletter Editor	2100/2200 Mistletoe Blvd.	2200 Weatherbee	
Kyle Carr 907-5759	Gil DeHoyos 926-6409	Susan Harwell 923-8806	
	2300/2400 Mistletoe Blvd.	1100 Clara	
	Lisa Stewart 924-9666	Abbie Steffler 922-0780	
Street Rep Captains	2100/2200 West Magnolia	1200 Clara	
Pat Hale (East) 924-5263	Sherry Choate 923-7335	Betty Arvin 924-7088	
Gaye Reed (West) 921-0009	2300 West Magnolia	1100 Buck	
Welcome Baskets	Susan Pressley 923-6061	Janet Gallagher 921-9027	
Joy Teague 923-2330	2100 Harrison	1200/1300 Buck	
Advertising Manager	Elizabeth Sims 926-3548	Simone Scott 924-3838	
Nancy Brown 923-7146	2200 Harrison & Jerome	2100 Morphy	
Newby Park	Scott Doty 924-2644	Debra Tice 921-4651	
Patsy Slocum 923-5510	2300/2400 Harrison	1100 Mistletoe Dr.	
City Liaison	Faye Dowdle 926-7571	Kim Musgrove 923-6785	
Vacant	2100 Mistletoe Ave.	1200 – 1500 Mistletoe Dr.	
Historian	Neataw Engels 927-2468	Rochelle Graham 927-2967	
Wyatt Teague 923-2330	2200 Mistletoe Ave.	2300 Mistletoe Dr.	
	Richard/Christi Yantis 924-2857	Sandy Tarpley 924-9215	
	2300 Mistletoe Ave.	Forest Park Blvd.	
MHA YEARLY DUES	Kathleen Walker 926-9095	Steve McReynolds 926-7955	
Dues are \$5, \$10, \$25 or more. Your dues help to defer the cost of this newsletter, the Mistletoe Heights phone directory and many other neighborhood functions. Dues are accepted by Alex Blanton (call for address - 926-7235).	Neighborhood Police Officer	Neighborhood Police Officer	
	East of Forest Park	West of Forest Park	
	Officer D. B. Briggs	Officer Jamie Johnson	
	Office 871-8948	Mobile 994-3409	
	Mobile 991-8473	Pager 998-0478	
	Email:	Email:	
	BriggsD@ci.fort-worth.tx.us	jamie.johnson@fortworthgov.org	